

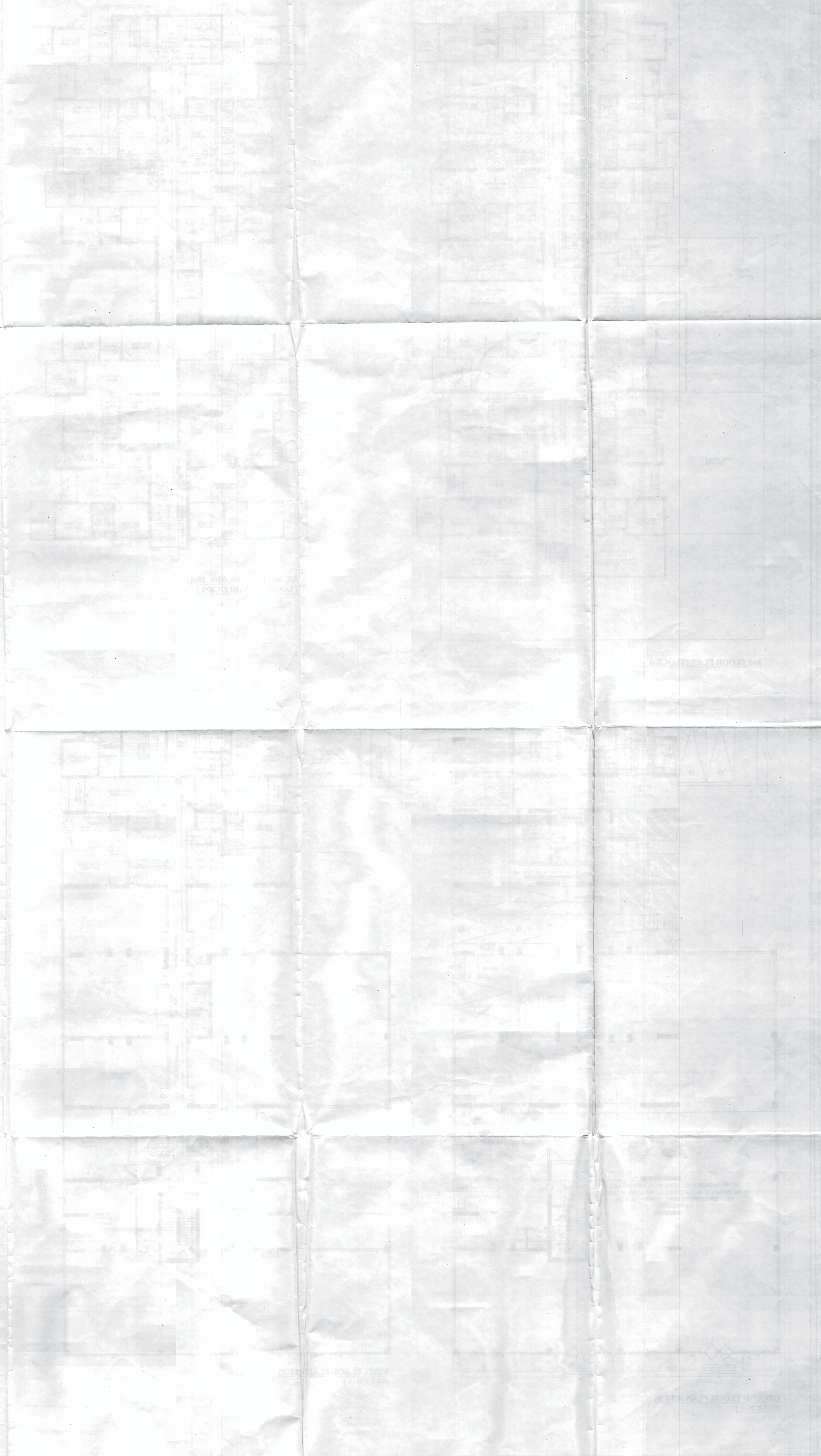

Building of building materials on a  
basis of the plan and the  
the Municipality may, without notice,  
the building on the plan.  
If the building is not built in accordance with the plan,  
the building shall be demolished.

Transfer of occupancy of any  
part of the building shall be  
subject to the approval of the  
Municipality.  
If the building is not built in accordance with the plan,  
the building shall be demolished.

When information is submitted to the  
Municipality, the applicant shall be  
responsible for the accuracy of the  
information.  
If the information is not accurate,  
the applicant shall be liable for the  
costs of the investigation and the  
costs of the correction of the  
information.



APPROVED  
Municipality

APPROVED  
Municipality

APPROVED  
Municipality

APPROVED  
Municipality

APPROVED  
Municipality

APPROVED  
Municipality

APPROVED  
Municipality

APPROVED  
Municipality

APPROVED  
Municipality

APPROVED  
Municipality

APPROVED  
Municipality

APPROVED  
Municipality

APPROVED  
Municipality